



TTAF[®] E-Bike Connectors & Cable Solutions

E-bikes are smart, compact vehicles that allow riders to enjoy nature and navigate tough conditions while being sustainably aware.

TTAF designs and manufactures e-bike connectors that meet all connection needs for an enjoyable ride.



Today, Tomorrow And Forever...

E-bike

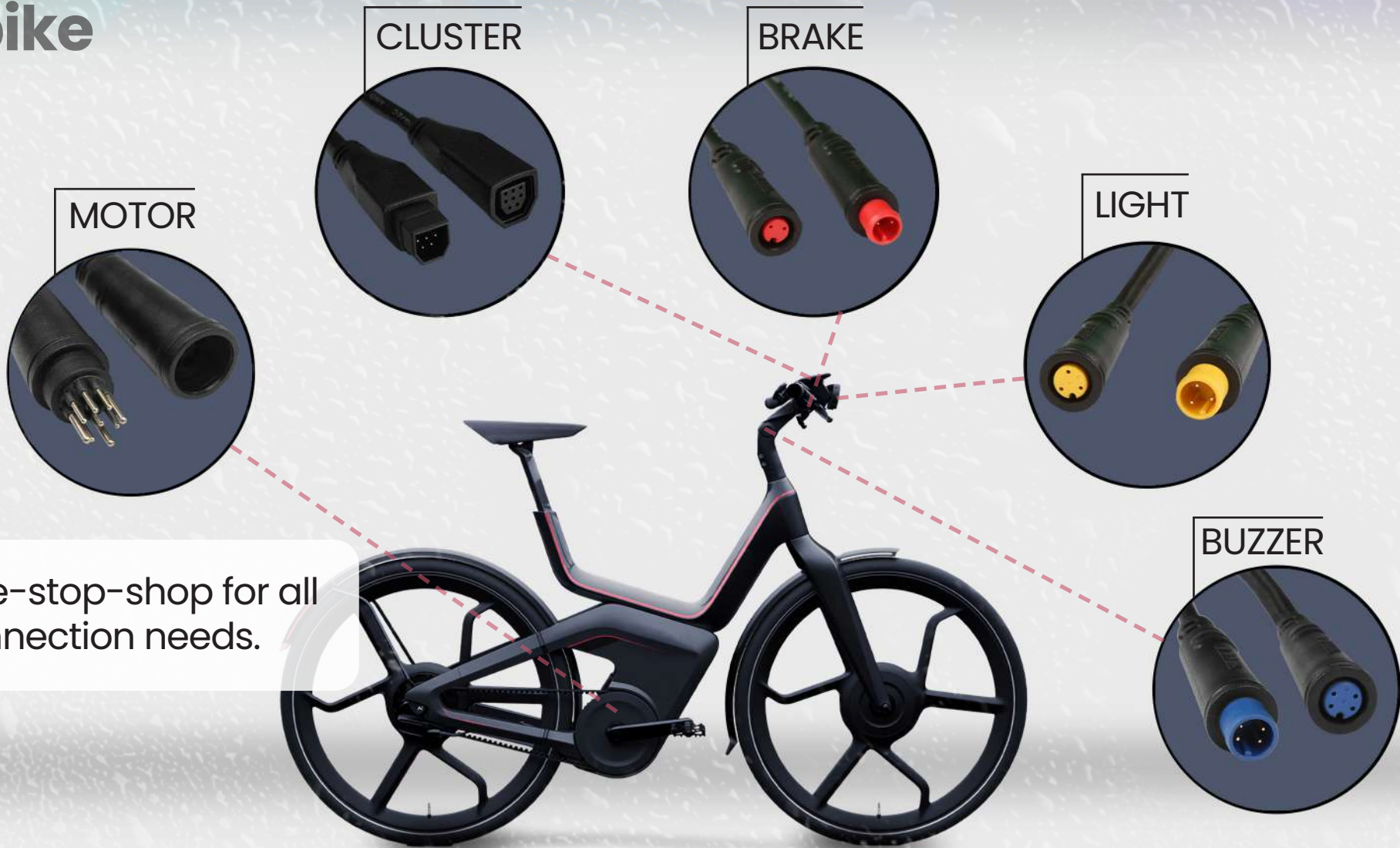
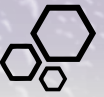

One-stop-shop for all connection needs.

M6

M8,M9,M10



E-motorbike

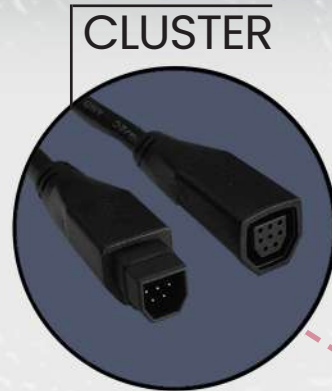
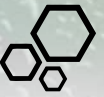

Overmolded cables with different lengths and color options.



M6

M8,M9,M10



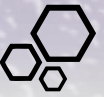

Hoverboard Scooter

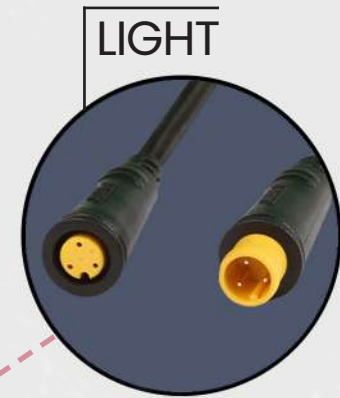
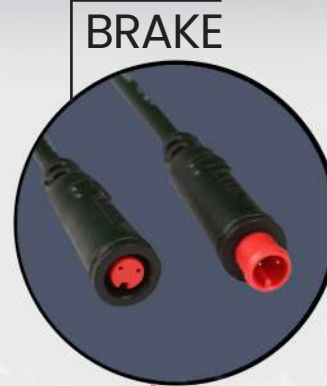
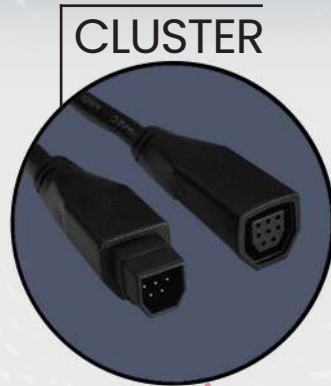

Easy-to fix.

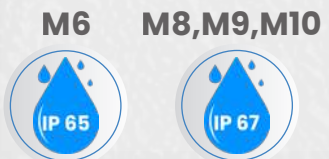

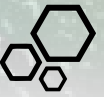

Electric Scooter

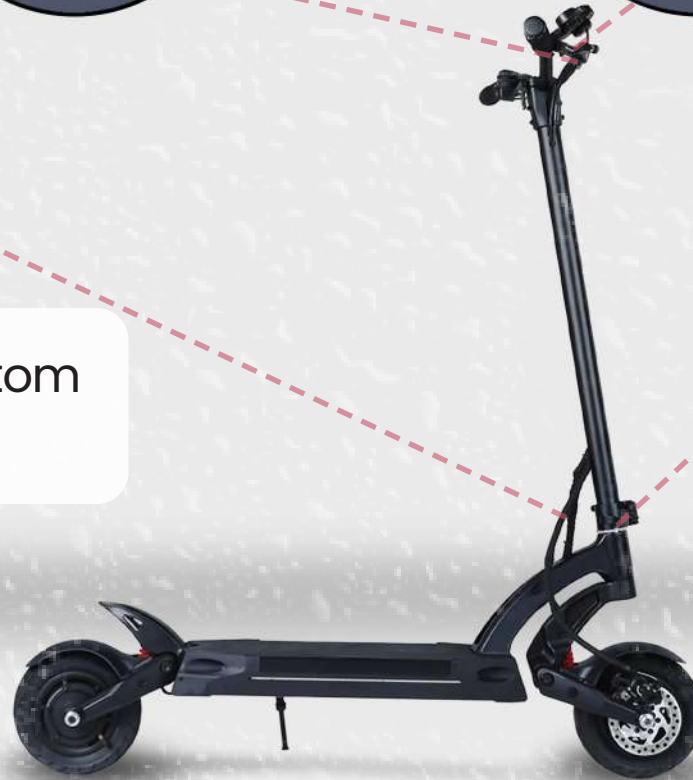
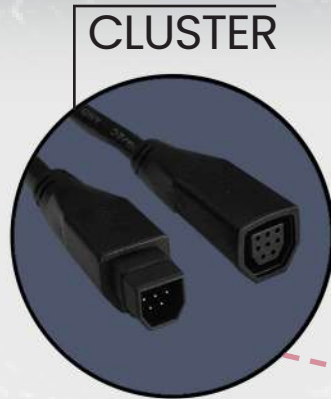

Custom designs and custom connector combinations.

M6

M8,M9,M10





M Series Waterproof Connectors & Cables

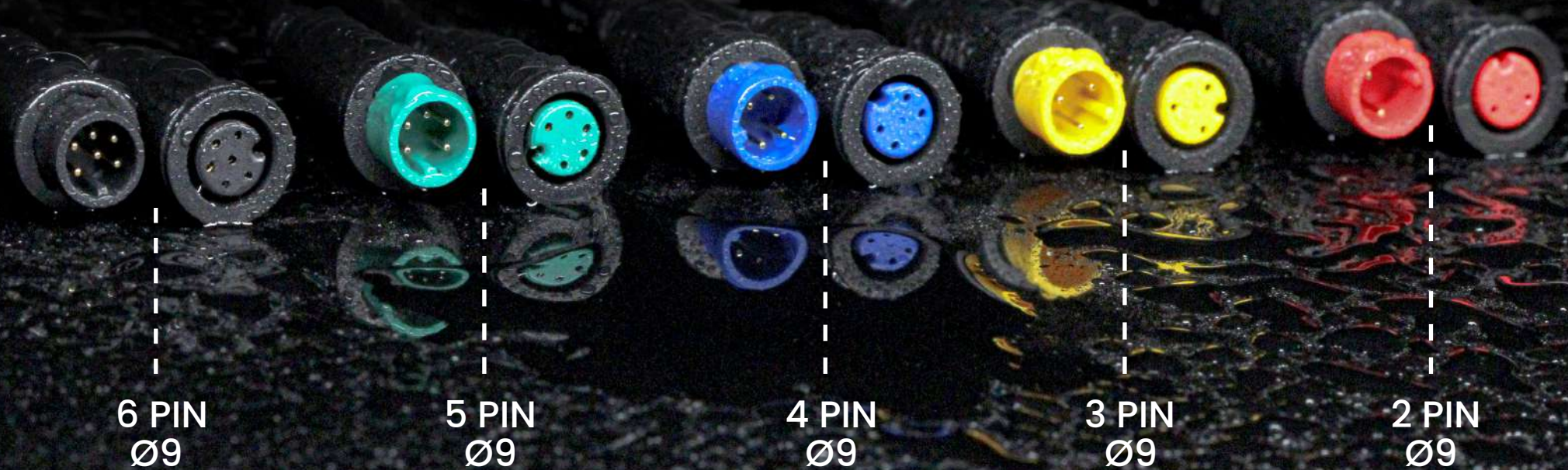

6 PIN
Ø9

5 PIN
Ø9

4 PIN
Ø9

3 PIN
Ø9

2 PIN
Ø9

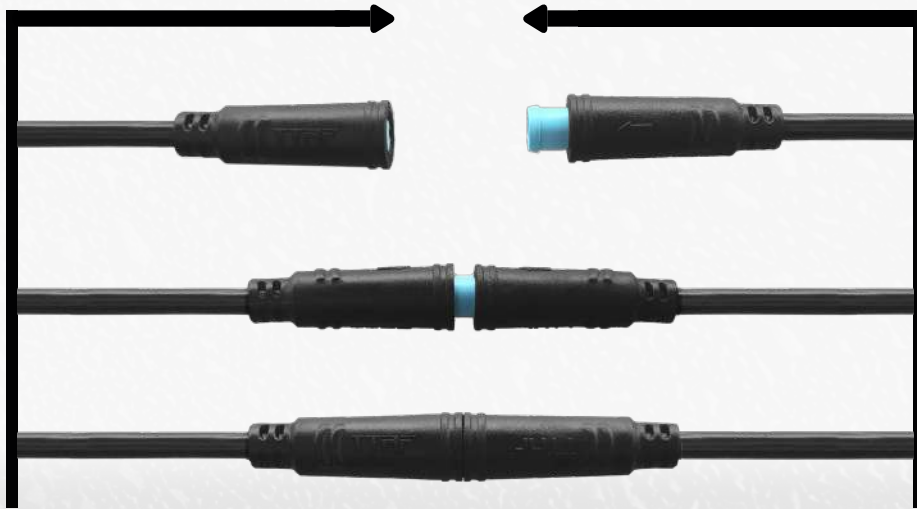
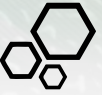

Smart And Compact

M Series Connectors are a flexible and reliable option that can be used in various applications. Thanks to their compact design and wire-to-wire connection features, they can be easily installed and maintained.

If you need to connect sensors, actuators or other devices, M Series connectors provide a safe and robust connection.

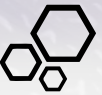

**M6-2 PIN
Male/Female**

Product Structure:	2 PIN
IP Class:	IP65
Ambient Temperature:	-20°C~+80°C
Rated Voltage:	60V
Withstand Voltage:	500V
Contact Resistance:	≤10mΩ
Insulation Resistance:	≥20MΩ



**M6-3 PIN
Male/Female**

Product Structure:	3 PIN
IP Class:	IP65
Ambient Temperature:	-20°C~+80°C
Rated Voltage:	60V
Withstand Voltage:	500V
Contact Resistance:	≤10mΩ
Insulation Resistance:	≥20MΩ



**M6-4 PIN
Male/female**

Product Structure:	4 PIN
IP Class:	IP65
Ambient Temperature:	-20°C~+80°C
Rated Voltage:	60V
Withstand Voltage:	500V
Contact Resistance:	≤10mΩ
Insulation Resistance:	≥20MΩ



**M6-5 PIN
Male/Female**

Product Structure:	5 PIN
IP Class:	IP65
Ambient Temperature:	-20°C~+80°C
Rated Voltage:	60V
Withstand Voltage:	500V
Contact Resistance:	≤10mΩ
Insulation Resistance:	≥20MΩ



**M6-6 PIN
Male/Female**

Product Structure:	6 PIN
IP Class:	IP65
Ambient Temperature:	-20°C~+80°C
Rated Voltage:	60V
Withstand Voltage:	500V
Contact Resistance:	≤10mΩ
Insulation Resistance:	≥20MΩ



**M8-2 PIN
Male/Female**

IP Class:	IP67
Ambient Temperature:	-25°C~+85°C
Rated Voltage:	48V
Withstand Voltage:	500V
Contact Resistance:	≤10mΩ
Insulation Resistance:	≥20MΩ
Mechanical Operation:	≤200 Matching Cycle
Cable Cross Section Area:	0.14m2~0.2m2



**M8-3 PIN
Male/Female**

IP Class:	IP67
Ambient Temperature:	-25°C~+85°C
Rated Voltage:	48V
Withstand Voltage:	500V
Contact Resistance:	≤10mΩ
Insulation Resistance:	≥20MΩ
Mechanical Operation:	≤200 Matching Cycle
Cable Cross Section Area:	0.14m2~0.2m2



**M8-4 PIN
Male/female**

IP Class:	IP67
Ambient Temperature:	-25°C~+85°C
Rated Voltage:	48V
Withstand Voltage:	500V
Contact Resistance:	≤10mΩ
Insulation Resistance:	≥20MΩ
Mechanical Operation:	≤200 Matching Cycle
Cable Cross Section Area:	0.14m2~0.2m2



**M8-5 PIN
Male/Female**

IP Class:	IP67
Ambient Temperature:	-25°C~+85°C
Rated Voltage:	48V
Withstand Voltage:	500V
Contact Resistance:	≤10mΩ
Insulation Resistance:	≥20MΩ
Mechanical Operation:	≤200 Eşleşme Döngüsü
Cable Cross Section Area:	0.14m2~0.2m2



**M8-6 PIN
Male/Female**

IP Class:	IP67
Ambient Temperature:	-25°C~+85°C
Rated Voltage:	48V
Withstand Voltage:	500V
Contact Resistance:	≤10mΩ
Insulation Resistance:	≥20MΩ
Mechanical Operation:	≤200 Matching Cycle
Cable Cross Section Area:	0.14m2~0.2m2



**M10 - 8 PIN
Male/Female**

Product Structure:	8 PIN
IP Class:	IP67
Ambient temperature:	-25°C~+85°C
Rated Voltage:	60V
Withstand Voltage:	700V
Contact Resistance:	≤10mΩ
Insulation Resistance:	≥20MΩ
Cable Cross Section Area:	0.2m2~2.0m2



**M10 - 9 PIN
Male/Female
3 Power + 6 Signal**

Product Structure:	9 PIN
IP Class:	IP67
Ambient temperature:	-25°C~+85°C
Rated Voltage:	60V
Withstand Voltage:	700V
Contact Resistance:	≤10mΩ
Insulation Resistance:	≥20MΩ
Cable Cross Section Area:	0.2m2~2.0m2



**M9 - 6 PIN
Male/Female
2 Power + 4 Signal**

Product Structure:	6 PIN
IP Class:	IP67
Ambient temperature:	-25°C~+85°C
Rated Voltage:	60V
Withstand Voltage:	700V
Contact Resistance:	≤10mΩ
Insulation Resistance:	≥20MΩ
Cable Cross Section Area:	0.2m2~2.0m2



M Series Waterproof Connectors & Cables



9 PIN
Ø14.5

6 PIN
Ø12.5

ARTICLE NUMBER BUILD-UP:

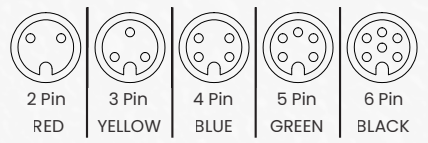
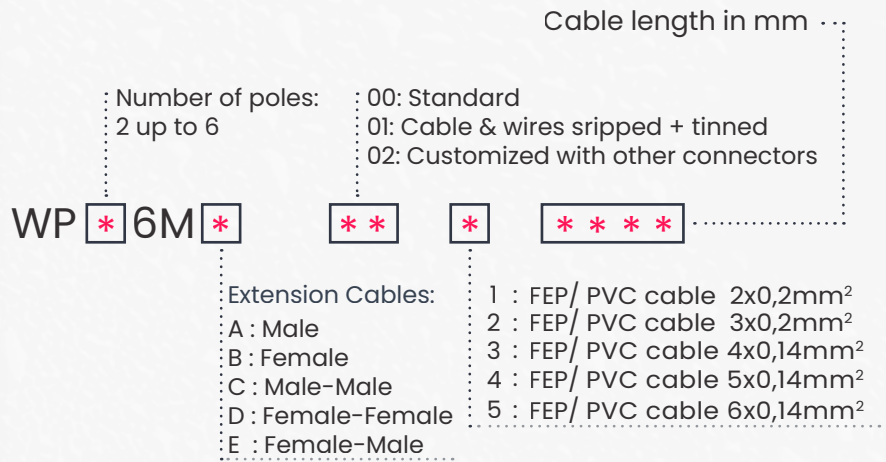

M6 Male

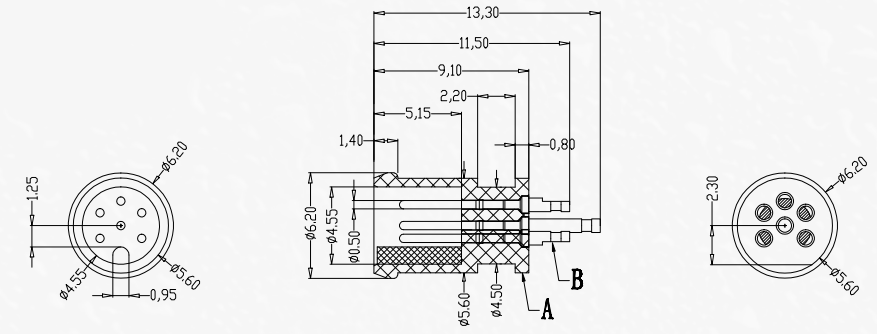

M6 Female

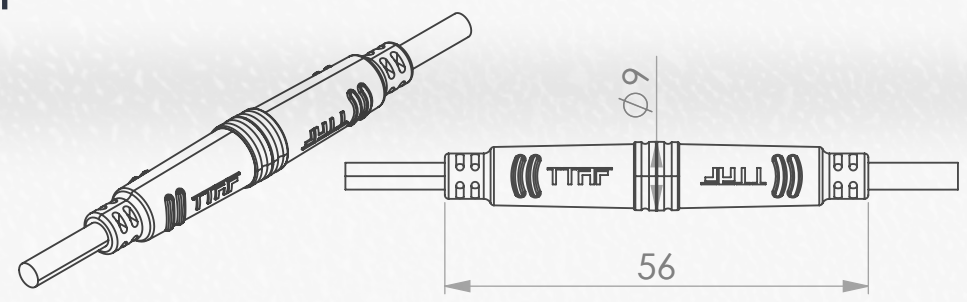
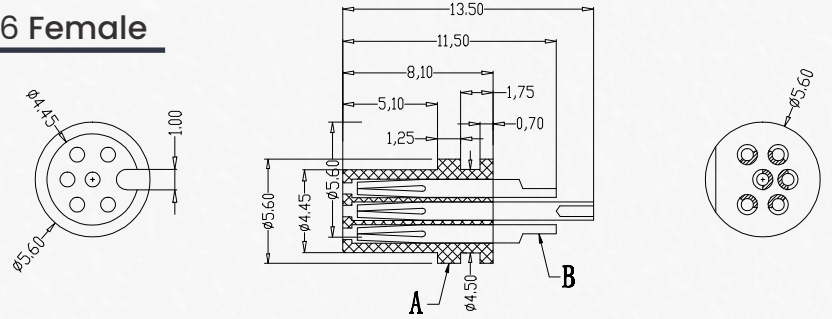



ARTICLE NUMBER BUILD-UP:

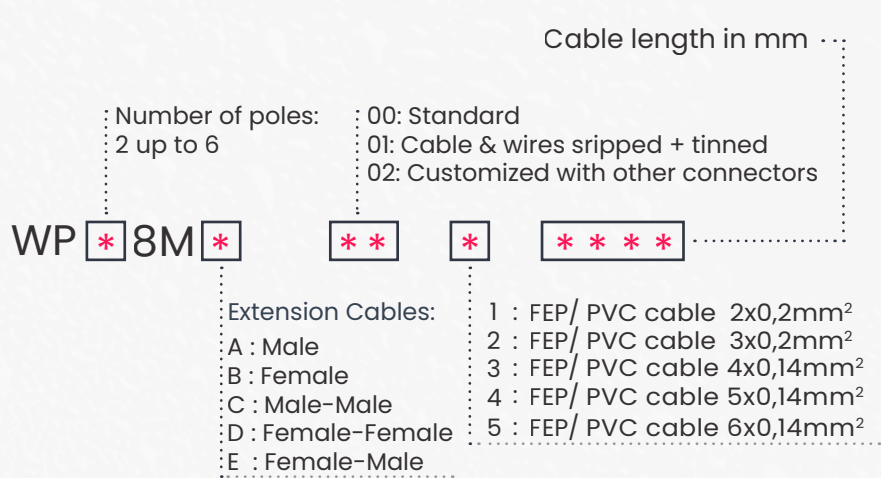

M8 Male

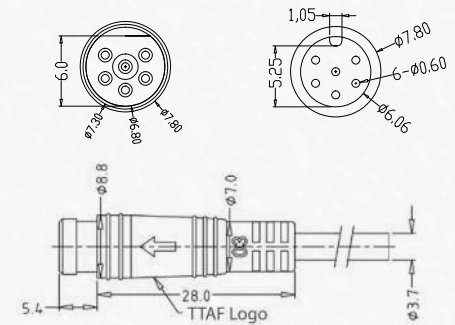
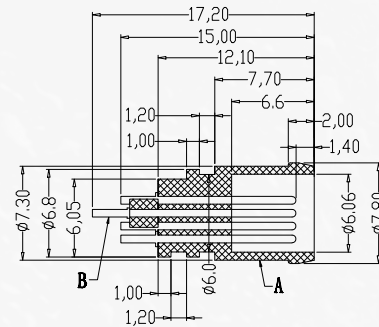

M8 Female

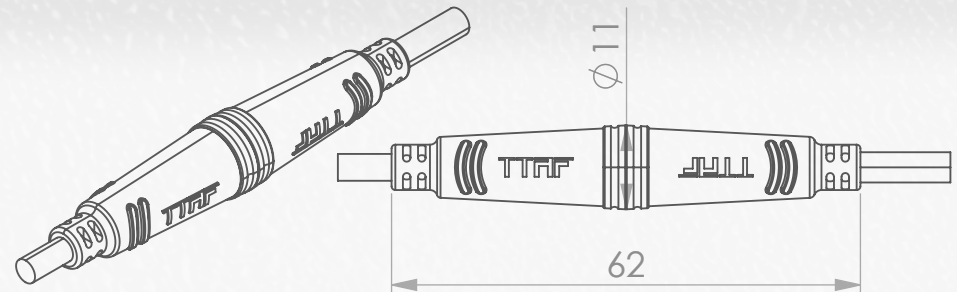
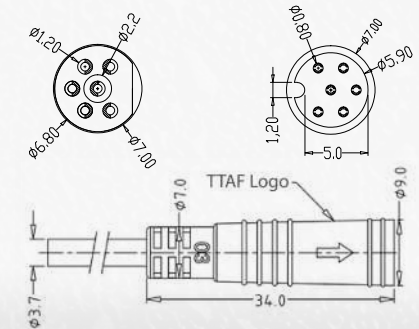
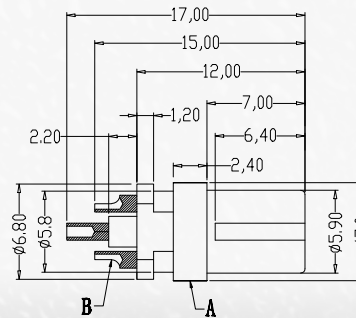

ARTICLE NUMBER BUILD-UP:

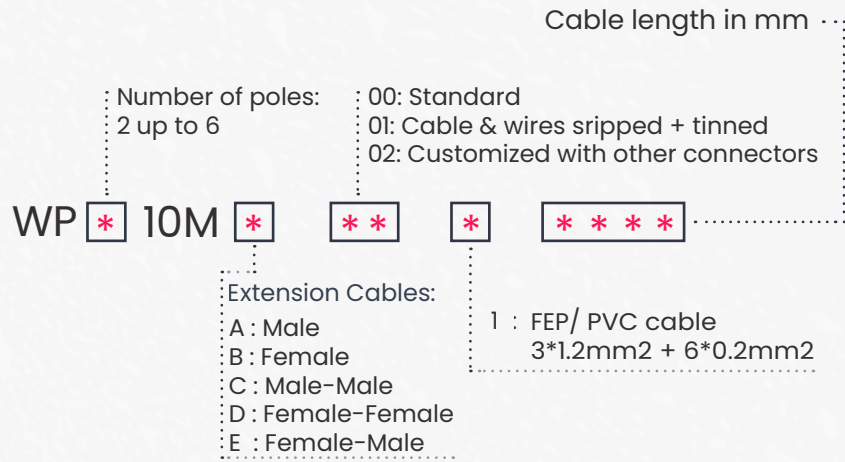

M10 - 9 PIN Male

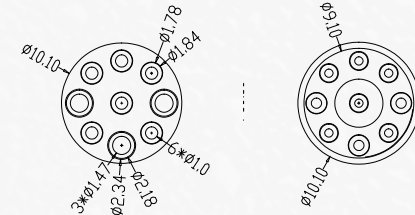
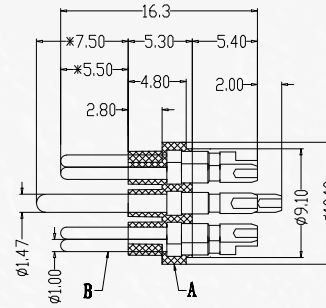

M10 - 9 PIN Female

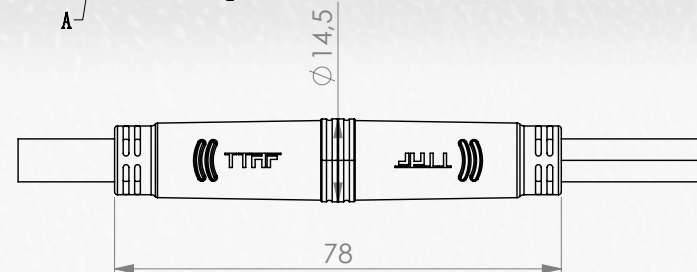
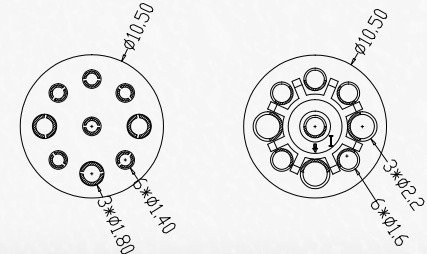
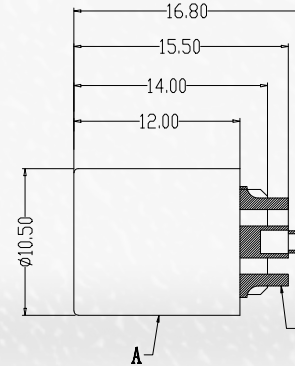

ARTICLE NUMBER BUILD-UP:

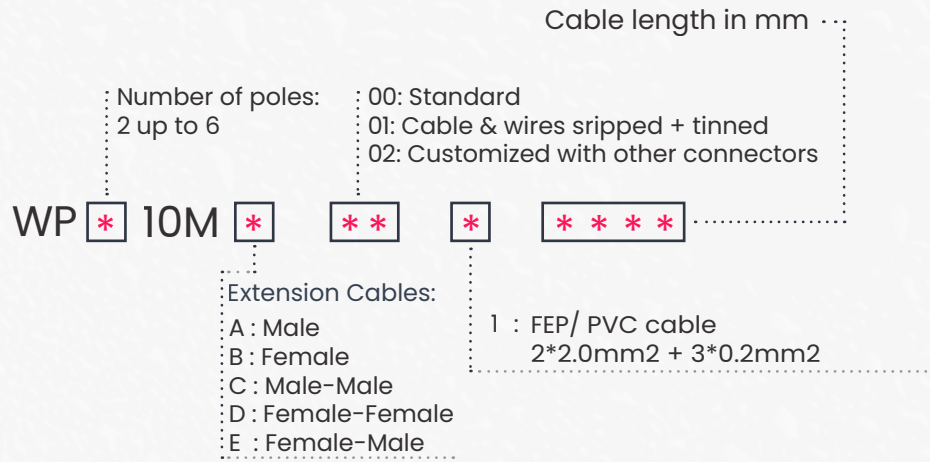

M10 - 8 PIN Male

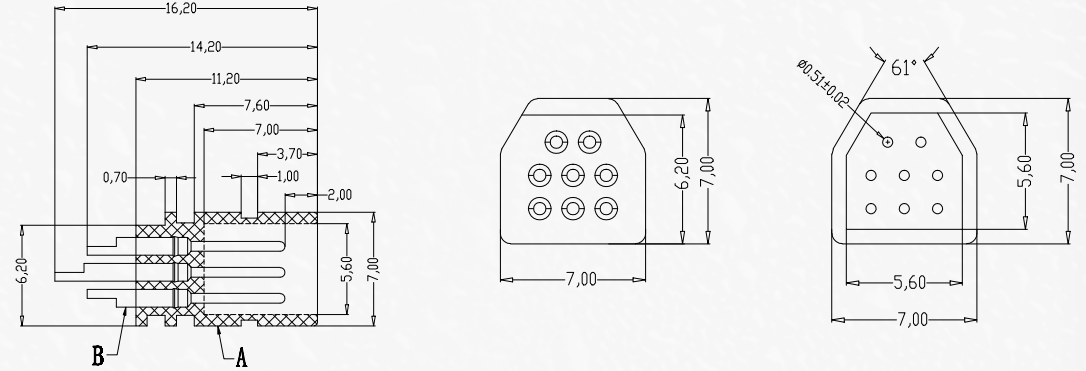

M10 - 8 PIN Female

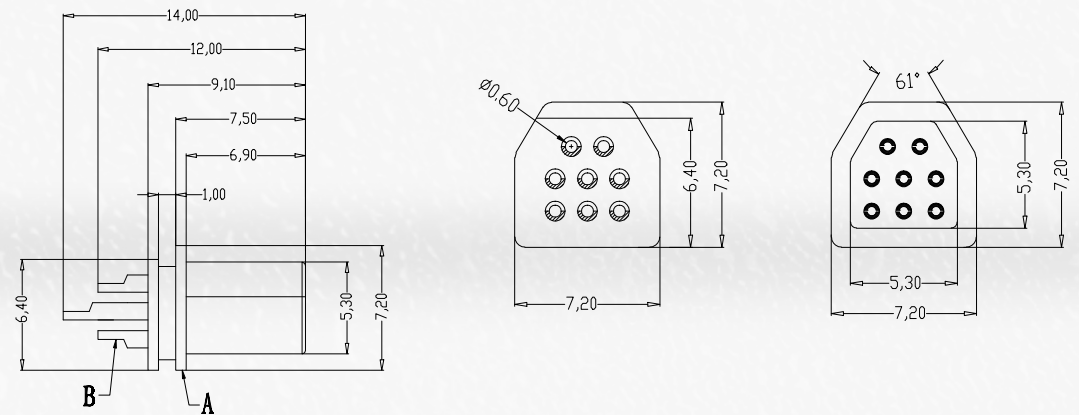

ARTICLE NUMBER BUILD-UP:

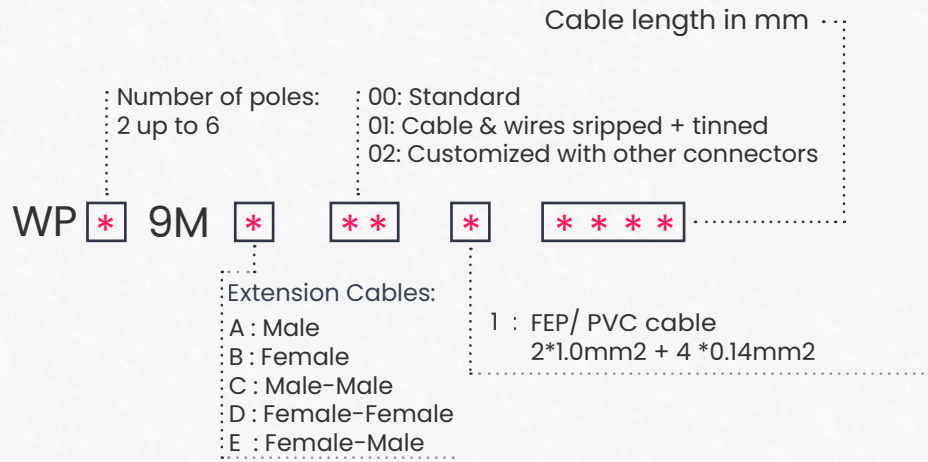

M9 - 6 PIN Male

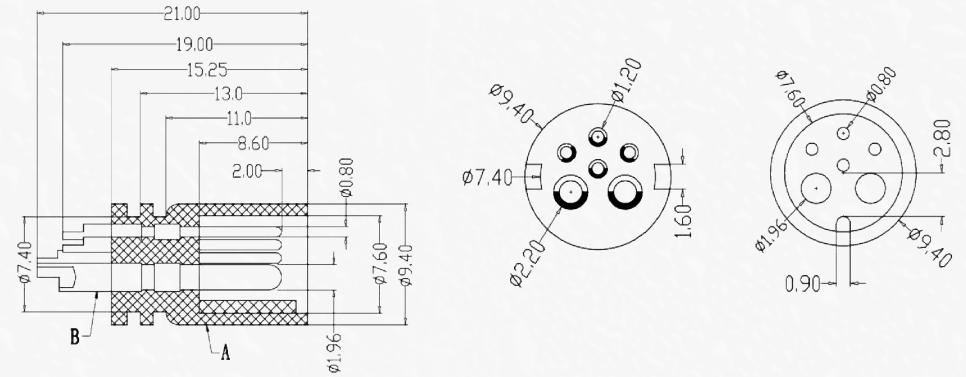

M9 - 6 PIN Female

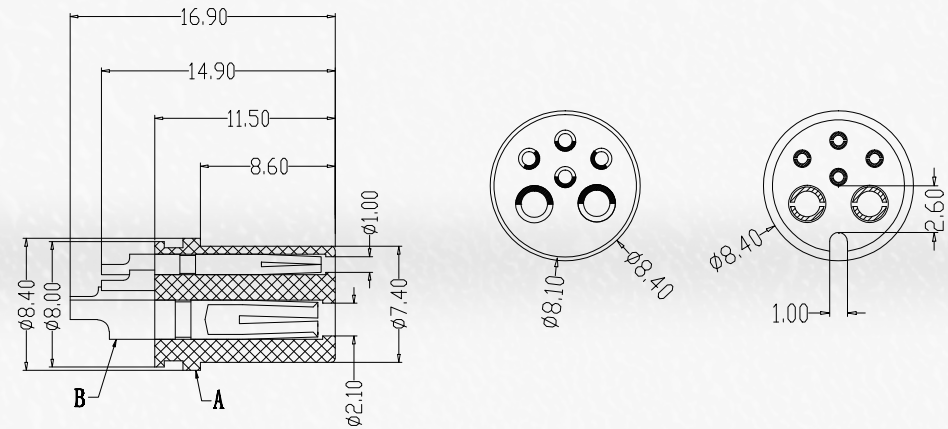

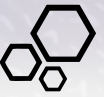

E-Bike Accessories

M6 and M8 Signal connectors can be combined with Power to Type-C or Power to Lightning. In this way, you can charge your phone or smart device with your e-bike.

Power to Type-C



Power to Lightning



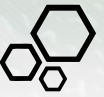

BATTERY HARNESS

In addition to connectors and overmolded cables; TTAF has the capabilities to provide any type of cable assemblies based on customer specifications.

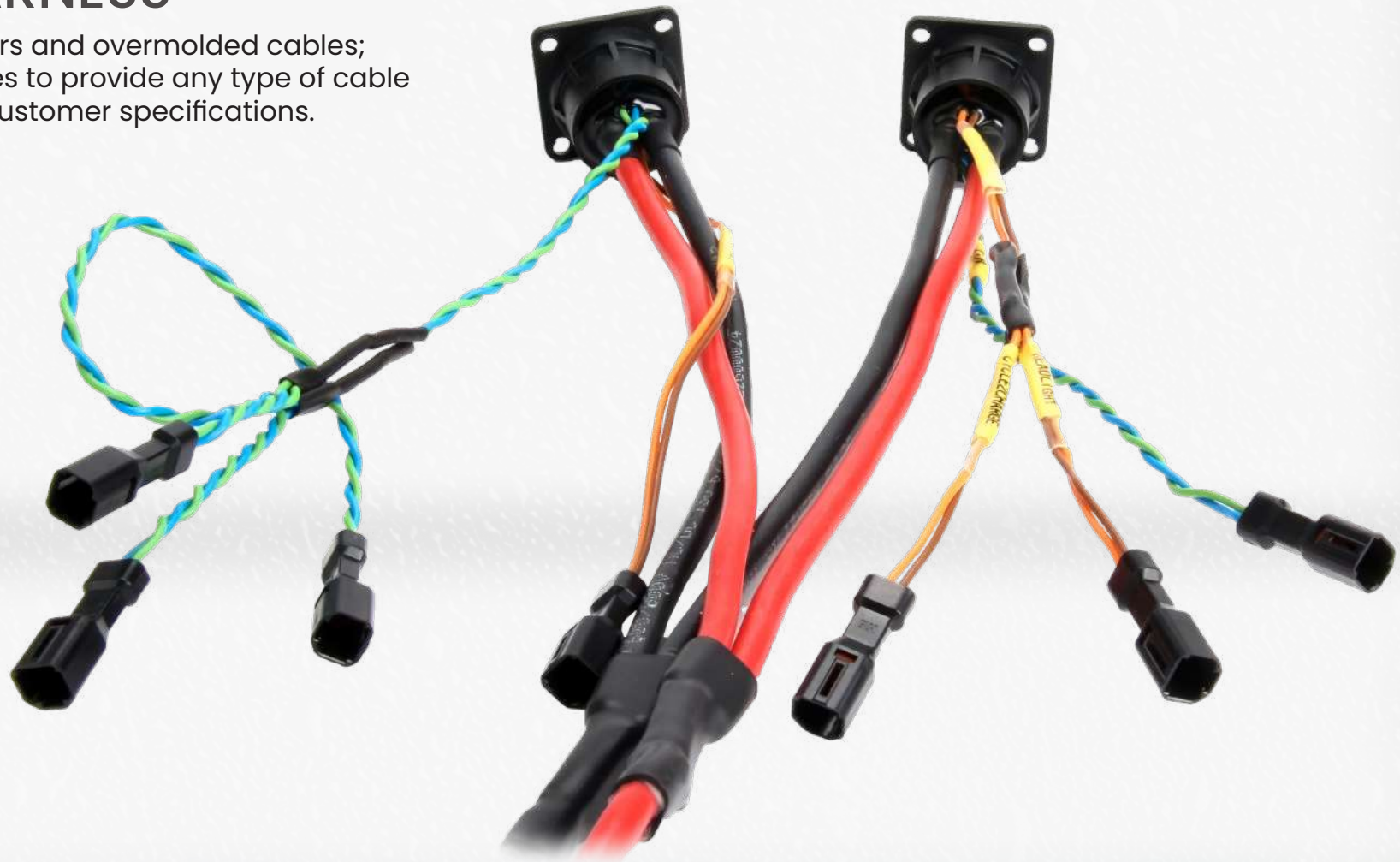



Enjoy The Ride!

www.ttafconsumer.com

