

VIEW	TOLERANCE	
	0-10	±1
	11-250	±5
UNIT: mm	261-500	±10
	501-1000	±20
	1001-3000	±50
	3001-5000	±100
	5001->	±150

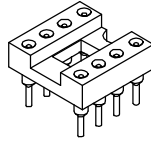
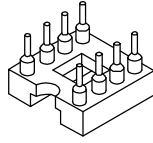

Δ Order Code : 1400-XX-P

Number of contact : 6 to 40 pin

**TTAF
APPROVAL**

Δ Material : Housing - P.B.T & Glass Fiber 30% UL94V-0
Pin - Phosphor Bronze

Voltage Rating : 500V AC,DC
Current Rating : 1AMP
Withstanding Voltage : 500V/minute
Insulation Resistance : 1000M Ω Min
Temperature Range : -55°C ~ + 105°C

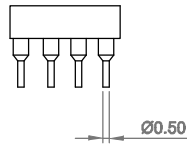
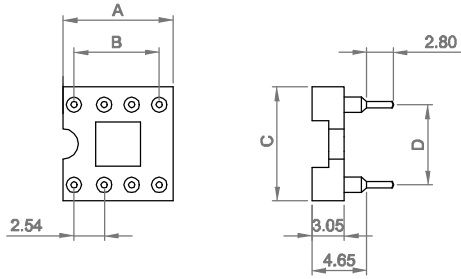

Contact No.	Dimensions(mm)			
	A	B	C	D
6	7.52	7.62	10.16	7.62
8	10.16	7.62	10.16	7.62
14	17.82	15.24	10.16	7.62
16	20.32	17.78	10.16	7.62
18	22.86	20.32	10.16	7.62
20	25.40	22.86	10.16	7.62
24	30.48	27.94	10.16	7.62
24	30.48	27.94	17.78	15.24
28	35.56	33.02	10.16	7.62
28	35.56	33.02	17.78	15.24
40	50.80	48.26	17.78	15.24

Date	03.11.2014	Rev.	-	Revision Detail		Rev.Dt.		Rev.by		Part No	1400-XX-P		
Designed by	Yeşim AKSOY									Drawing Nr.		Scale	Sheet No
Checked by	Fatih BOLACA									-		NONE	1/1



1

2

3

4

5

6

A4